

PREMIER SOUTH LAKE UNION LOCATION OFFICE & RETAIL SPACE FOR LEASE



1500 Westlake Avenue North, Seattle WA 98109

Marina Mart Building

- View office with deck
 - 1,295 SF available October 2014
 - \$27/sf/yr full service
- Retail space available
 - 468 SF with street frontage
 - \$25/sf/yr full service
- Minutes to downtown Seattle, Lake Washington and Puget Sound
- Call for tour



Street Retail

**YATES
WOOD**

**BROKERAGE
& PROPERTY
MANAGEMENT**

For more information, please contact:

Dennis Counts 206 268 3312
dcounts@yateswood.com

Mike McKinstry 206 268 3315
mike@yateswood.com

The information contained herein has been given to YW&M by the owners or sources that we deem reliable. We have no reason to doubt its accuracy, but we do not guarantee information contained herein.

Since 1944

Yates, Wood & MacDonald, Inc., 425 Pontius Ave N Suite 203, Seattle, WA 98109
f 206 268 3330 p 206 268 3300 www.yateswood.com

Lake Level Space

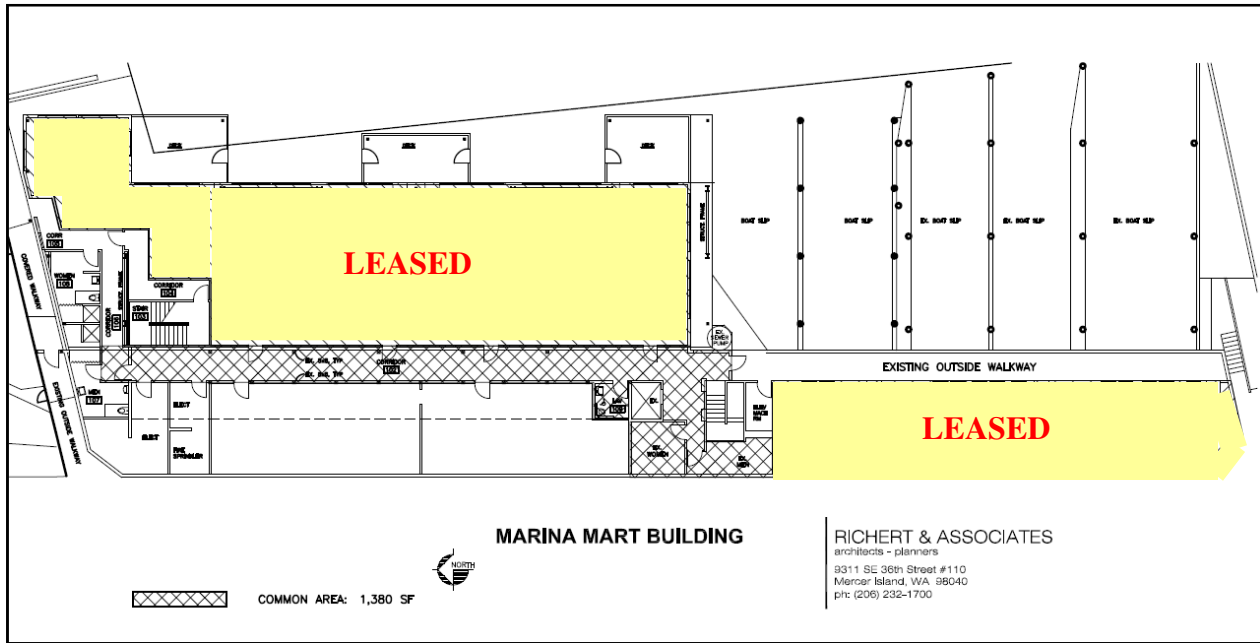

First Floor Space

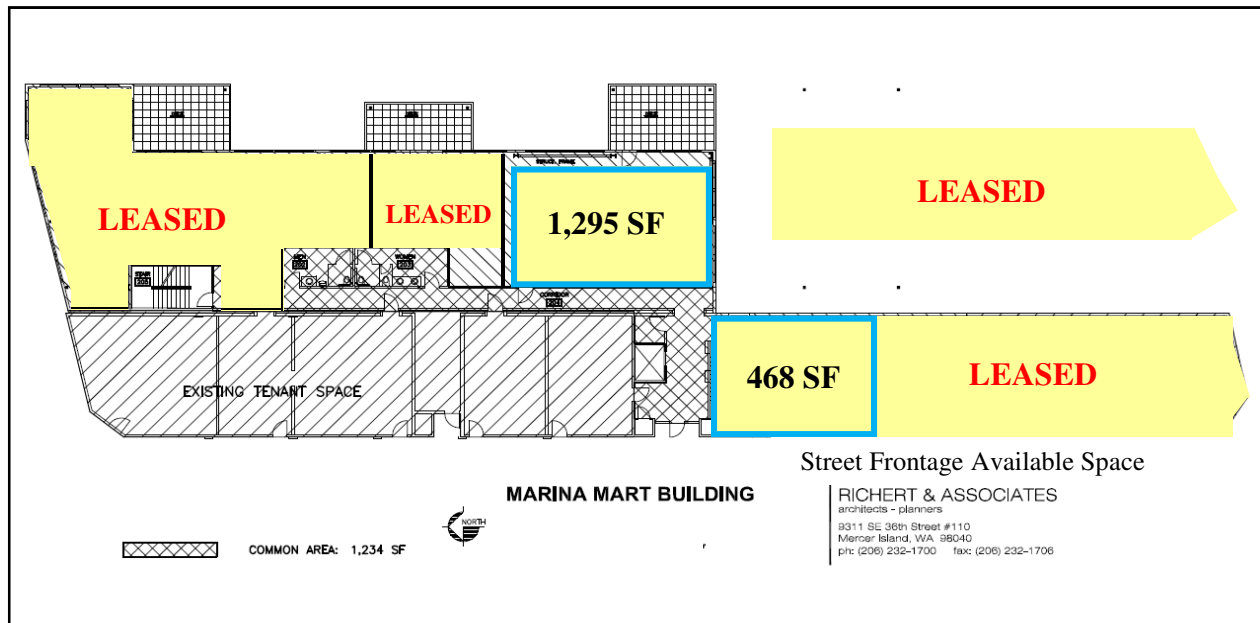

**YATES
WOOD**

**BROKERAGE
& PROPERTY
MANAGEMENT**

**1500 Westlake Avenue North
Seattle, WA 98109**

Since 1944

1,295 SF OFFICE SPACE



**YATES
WOOD**

**BROKERAGE
& PROPERTY
MANAGEMENT**

**1500 Westlake Avenue North
Seattle, WA 98109**

Since 1944